



(Sponsored by: Brilliant Grammar School Educational Society-Hyderabad)

(Approved by AICTE, New Delhi, Affiliated to JNTU-Hyderabad)

(Accredited by "NAAC" with "A" Grade)

Abdullapur (V), Abdullapurmet (M), R.R. Dist – 501505, Telangana, India

Website: www.b-iet.ac.in, e-mail: principal@b-iet.ac.in Contact No.: +919652929786



Date: 27.04.2024

TO WHOMEVER IT MAY CONCERN

I, Kasireddy Narayan Reddy , Secretary , **Brilliant Institute of Engineering & Technology** is hereby stating that, the River/ Canals/Rail Tracks/Highways/ High Tension line or any other such entity are not passing through the Site. this is for your kind Information.

SECRETARY



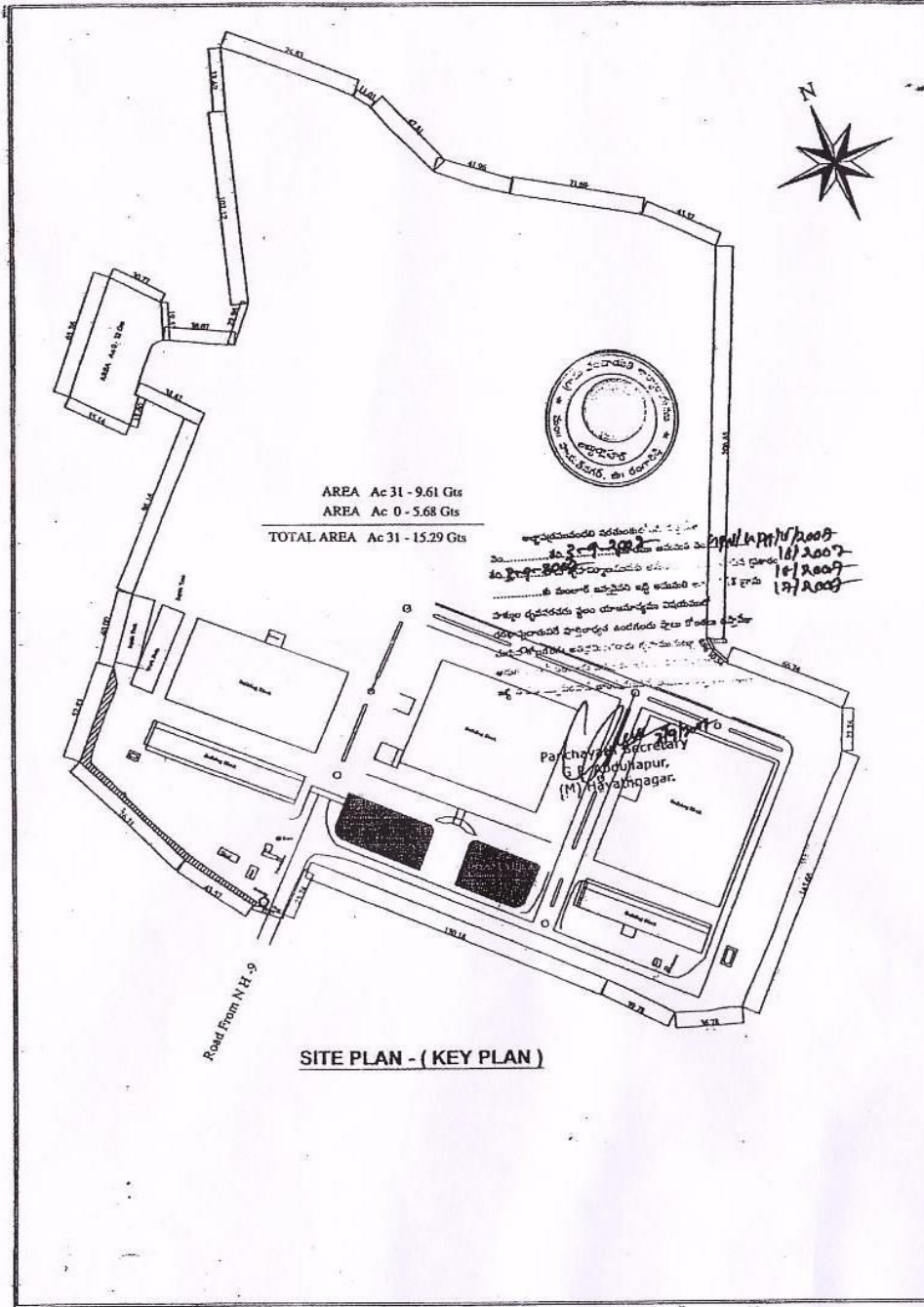

SITE PLAN SHOWING THE EXISTING EDUCATIONAL BUILDING IN SY. NO'S 48 & 49, 41, 49, 50 & 51, 41, 47, 48, 49, 50 & 51 SITUATED AT : ABDULLAPUR (V), ABDULLAPURMET (M), RANGA REDDY DIST. T.S

BELONGS TO: **BRILLIANT GROUP OF TECHNICAL INSTITUTIONS (SPONSORED BY BRILLIANT GRAMMAR SCHOOL EDUCATIONAL SOCIETY)**

1) M/S. BRILLIANT INSTITUTE OF ENGINEERING & TECHNOLOGY
 2) M/S. KASIREDDY NARAYAN REDDY COLLEGE OF ENGINEERING & RESEARCH
 3) M/S. BRILLIANT GRAMMAR SCHOOL EDUCATIONAL SOCIETY'S GROUP OF INSTITUTIONS - INTEGRATED CAMPUS

REPRESENTED BY ITS SECRETARY: **K. NARAYAN REDDY**

1) M/S. BRILLIANT INSTITUTE OF ENGINEERING & TECHNOLOGY
 EXISTING GROUND FLOOR SLAB AREA : 4928.72 sq.mt
 EXISTING FIRST FLOOR SLAB AREA : 4342.14 sq.mt
 EXISTING SECOND FLOOR SLAB AREA : 4342.14 sq.mt
 EXISTING THIRD FLOOR SLAB AREA : 4342.14 sq.mt
 EXISTING FOURTH FLOOR SLAB AREA : 4342.14 sq.mt
 TOTAL BUILT UP AREA : 22,297.28 sq.mt

2) M/S. KASIREDDY NARAYAN REDDY COLLEGE OF ENGINEERING & RESEARCH - (BLOCK-1)
 EXISTING GROUND FLOOR SLAB AREA : 2959.60 sq.mt
 EXISTING FIRST FLOOR SLAB AREA : 2959.60 sq.mt
 EXISTING SECOND FLOOR SLAB AREA : 2959.60 sq.mt
 EXISTING THIRD FLOOR SLAB AREA : 2959.60 sq.mt
 EXISTING FOURTH FLOOR SLAB AREA : 2959.60 sq.mt
 TOTAL BUILT UP AREA : 14,798.00 sq.mt

3) M/S. KASIREDDY NARAYAN REDDY COLLEGE OF ENGINEERING & RESEARCH - (BLOCK-2)
 EXISTING GROUND FLOOR SLAB AREA : 1013.15 sq.mt
 EXISTING FIRST FLOOR SLAB AREA : 1013.15 sq.mt
 EXISTING SECOND FLOOR SLAB AREA : 1013.15 sq.mt
 EXISTING THIRD FLOOR SLAB AREA : 1013.15 sq.mt
 EXISTING FOURTH FLOOR SLAB AREA : 1013.15 sq.mt
 TOTAL BUILT UP AREA : 5065.75 sq.mt

4) M/S. BRILLIANT GRAMMAR SCHOOL EDUCATIONAL SOCIETY'S GROUP OF INSTITUTIONS - INTEGRATED CAMPUS (ENGINEERING) : BLOCK-1
 EXISTING GROUND FLOOR SLAB AREA : 2812.85 sq.mt
 EXISTING FIRST FLOOR SLAB AREA : 2812.85 sq.mt
 EXISTING SECOND FLOOR SLAB AREA : 2812.85 sq.mt
 EXISTING THIRD FLOOR SLAB AREA : 2812.85 sq.mt
 EXISTING FOURTH FLOOR SLAB AREA : 2812.85 sq.mt
 TOTAL BUILT UP AREA : 14084.25 sq.mt

5) M/S. BRILLIANT GRAMMAR SCHOOL EDUCATIONAL SOCIETY'S GROUP OF INSTITUTIONS - INTEGRATED CAMPUS (PHARMACY) - BLOCK-2
 EXISTING GROUND FLOOR SLAB AREA : 1162.03 sq.mt
 EXISTING FIRST FLOOR SLAB AREA : 1162.03 sq.mt
 EXISTING SECOND FLOOR SLAB AREA : 1162.03 sq.mt
 EXISTING THIRD FLOOR SLAB AREA : 1162.03 sq.mt
 EXISTING FOURTH FLOOR SLAB AREA : 1162.03 sq.mt
 TOTAL BUILT UP AREA : 5810.15 sq.mt

TOTAL BUILT UP AREA : 62035.43 sq.mt